



20" 180W Dual Row LED Lightbar

#QVWL180D

www.qvee.com.au



DESCRIPTION

The QVEE 180W dual row high powered LED light bar has 36 x 5W High powered Osram® LED's with refraction styled reflectors and optics, putting out a massive 15,120 Lumens. Heavy duty aluminium housing with a heatsink construction for heat dispersion and virtually unbreakable polycarbonate lens. Water and dust proof up to IP67.

Shock and vibration resistant.

ACCESSORIES

- Channel Mounting Brackets
- Side Leg Mounting Brackets

IP67

DRIVING

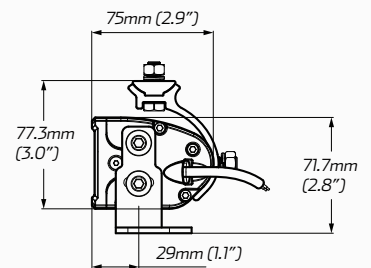
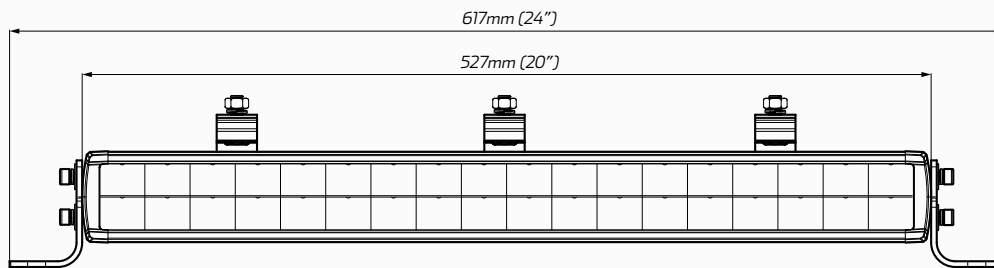
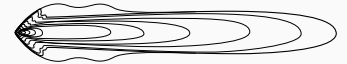

BEAM COVERAGE

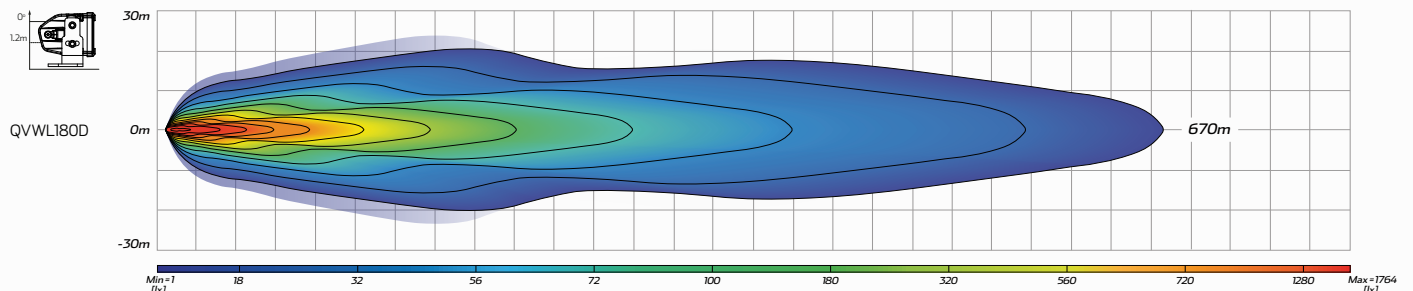

TECHNICAL SPECIFICATIONS

Voltage	• 10 - 48 Volt DC	Colour Temperature	• 5700 K
Wattage	• 180 Watt	Approvals	• ECE R112, ECE R10
IP Rating	• IP67 Rated	Beam Coverage	• Driving Beam
Raw Lumens	• 15,120 Lumens	Dimensions (with Legs)	• 24" L x 2.8" H x 2.9" D • 617mm L x 71.7mm H x 75mm D
Effective Lumens	• 12,403 Lumens	Accessories	• DT Connector • Side Leg Mounting Brackets • Channel Mounting Brackets
LED Count	• 36 x 5W Osram® LED's		